

LOC	QTY	REV	DATE	BY	CHK	APPV
CM	53					

REVISIONS						
REV	DESCRIPTION	DATE	BY	CHK	APPV	REASON
C	REV & REDWN PER EC 0L30-0270-97	12-11-97	KW			R5

AMP LOGO AND CAVITY NUMBER LOCATED THIS SURFACE.

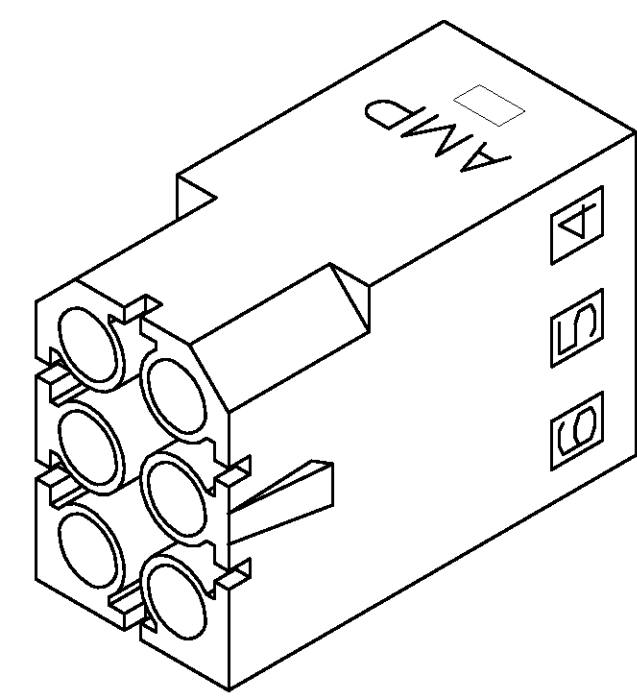
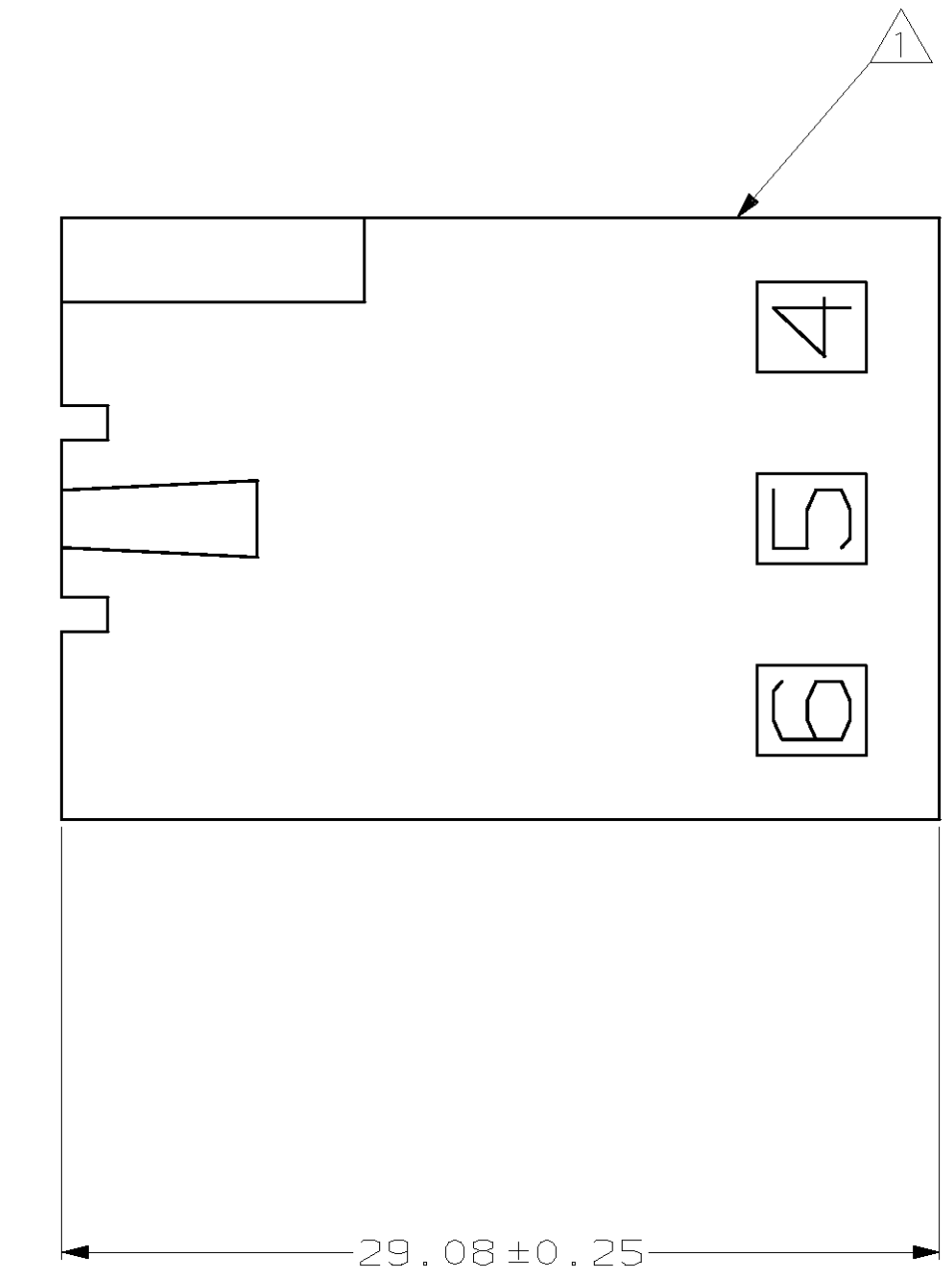
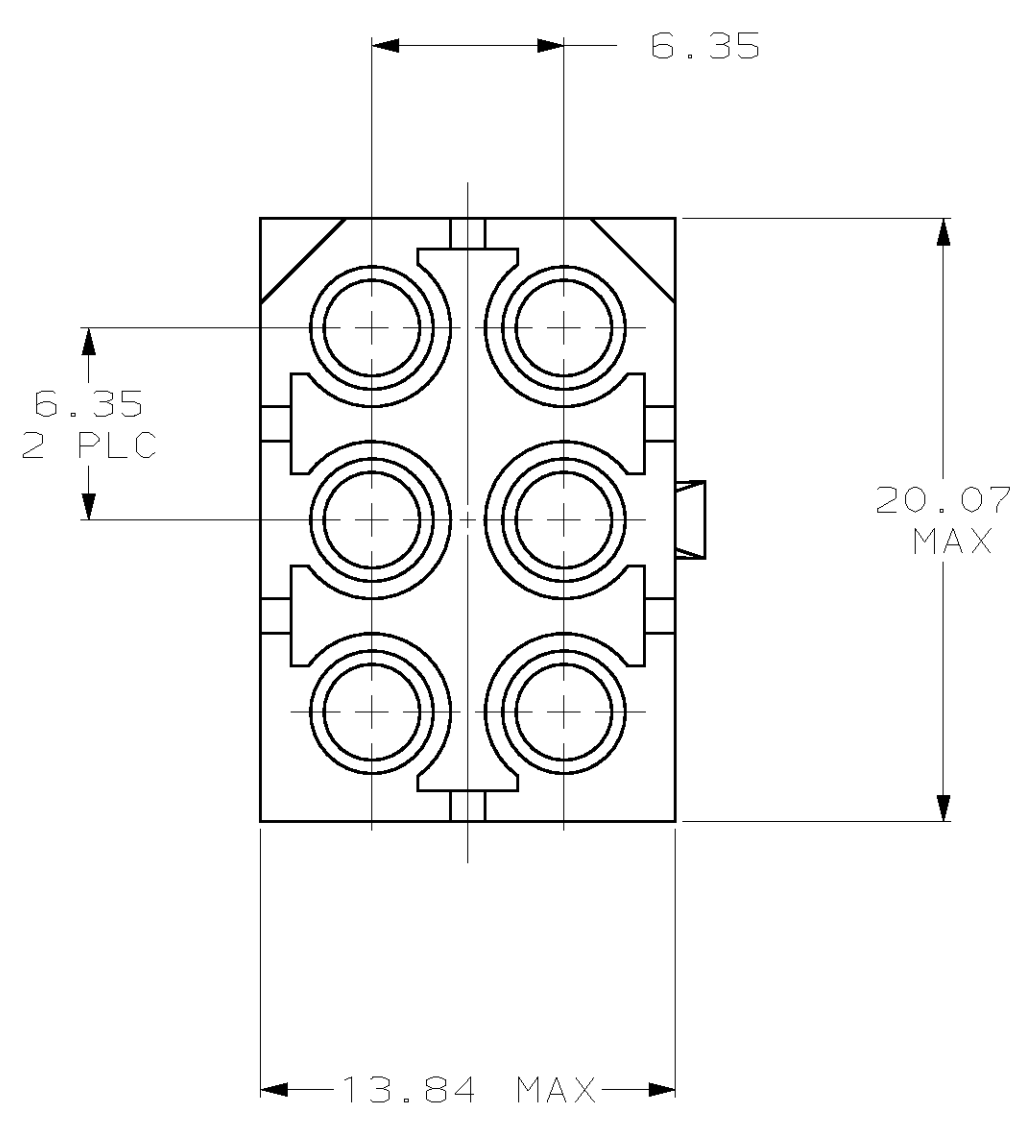
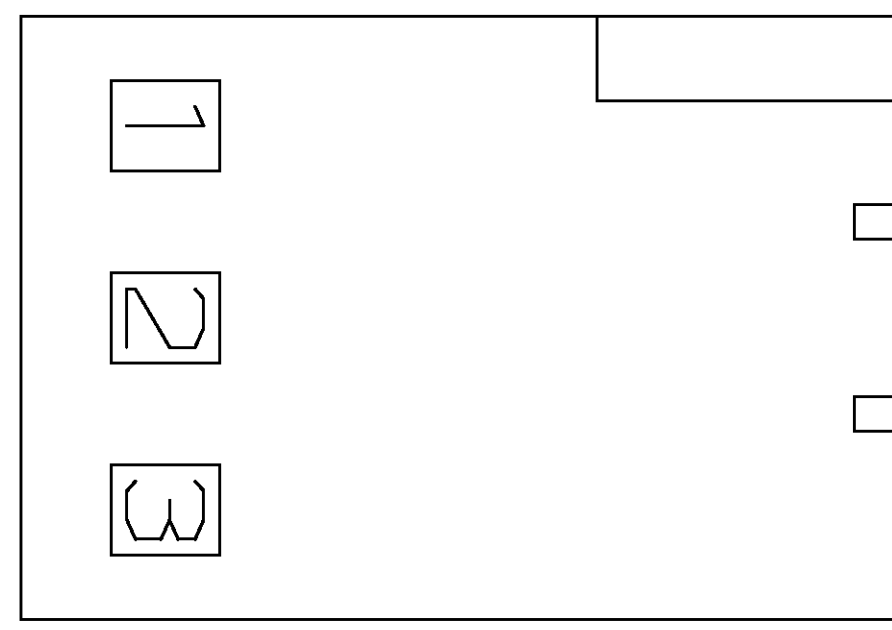

3-DIMENSIONAL MODEL  
NTS

MM	IN
29.08	1.145
20.07	.790
13.84	.545
6.35	.250
0.25	.010
0.13	.005

CONVERSION TABLE

770360-1  
PART NUMBER

**METRIC**

THIS DRAWING IS A CONTROLLED DOCUMENT.		DWN: K. WHITAKER 12-11-97		AMP Incorporated Harrisburg, PA 17105-3608	
DIMENSIONS: mm		CHK: R. SWING 12-11-97		APVD: K. CORLE 12-11-97	
TOLERANCES UNLESS OTHERWISE SPECIFIED:		PRODUCT SPEC		RECEPTACLE, 6 CIRCUIT, .250 PIN AND SOCKET	
0 PLC ±-		APPLICATION SPEC		SIZE: A1	
1 PLC ±-.13		HEIGHT		SCALE: 4:1	
2 PLC ±-.13		CUSTOMER DRAWING		SHEET 1 OF 1	
3 PLC ±-		MATERIAL: NYLON, UL 94V-2, NATURAL		DRAWING NO: 770360	
4 PLC ±-		FINISH: -		REV: C	
ANGLES		RESTRICTED TO		REV: C	